

PEER Perfectly Pairs!



PEER Chain StickerPlus™ & EnduroLife™

*The Best Choice for
Thermoforming Processes*

Distributed by:

 
Quality Links That Last.™ PEER Perfectly Pairs.™



StickerPlus™ — The Best in Value

PEER Chain's StickerPlus™ thermoforming chains delivers quality links that last to provide the best value in sticker chain. With six different tip styles, optional SK saddles and customized D-3 Extend-Pin locations, StickerPlus™ chain is the go-to industry choice to meet the demanding needs for each application. Using state of the art manufacturing technology PEER's StickerPlus™ thermoforming chains reduce elongation caused by wear and increase machine up-time.

Examples of PEER Sticker and Pin Attachments

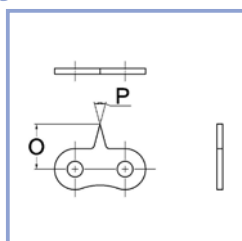

ST

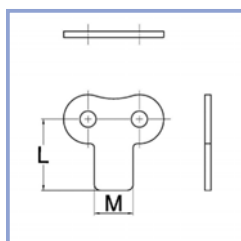

SK-0

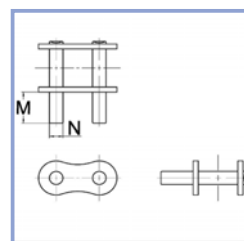

D-3

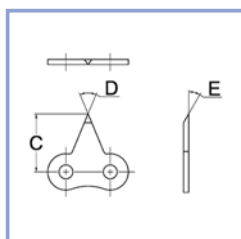

SHST

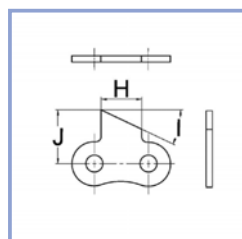

SHDST

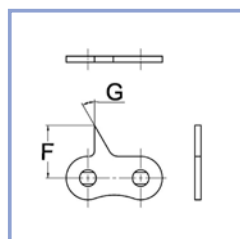

SLST

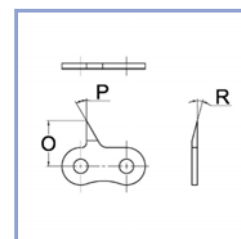

SHSLST

Choose the Sticker Chain to Match Your Needs

Chain Size	Pitch (P)	Quest	Frequency of Sticker	Frequency of SK-1 Saddle	Frequency of D-3 Extended Pins	Sharpened Points	Assembly Style
40	0.500"	Yes	2 and 4 Link	2 and 4 Link	2 and 4 Link	Both Available	Riveted and C/L
40-2	0.500"	Yes	2 and 4 Link	Ask PEER!	Ask PEER!	Both Available	Riveted and C/L
50	0.625"	Yes	2 and 4 Link	2, 4, 6, 8, 10, and 12 Link	2 and 4 Link	Both Available	Riveted and C/L
50-2	0.625"	Yes	2 Link	Ask PEER!	Ask PEER!	Yes	Riveted
08B	0.500"	Yes	2 Link	Ask PEER!	Ask PEER!	Yes	Riveted
08B-2	0.500"	Yes	2 Link	Ask PEER!	Ask PEER!	Yes	Riveted
10B	0.625"	Yes	2 Link	Ask PEER!	Ask PEER!	Yes	Riveted
10B-2	0.625"	Yes	2 Link	Ask PEER!	Ask PEER!	Yes	Riveted



EnduroLife™ — The Ultimate Performance!

PEER Chain's EnduroLife™ Sticker Chain has been engineered to meet the demanding requirements of the thermoforming industry. PEER's innovative chain design team utilized advanced methods for manufacturing to optimize chain life by reducing wear on the outer surface of the pin and inner surface of the bushing. These engineering chain enhancements increase wear life, and reduce down time and maintenance costs.

PEER EnduroLife™ Surpasses the Competition

Throughout the PEER Chain wear-life testing on other premium series sticker chains, PEER Chain EnduroLife™ Sticker Chain consistently outlasted others in wear life performance as shown.

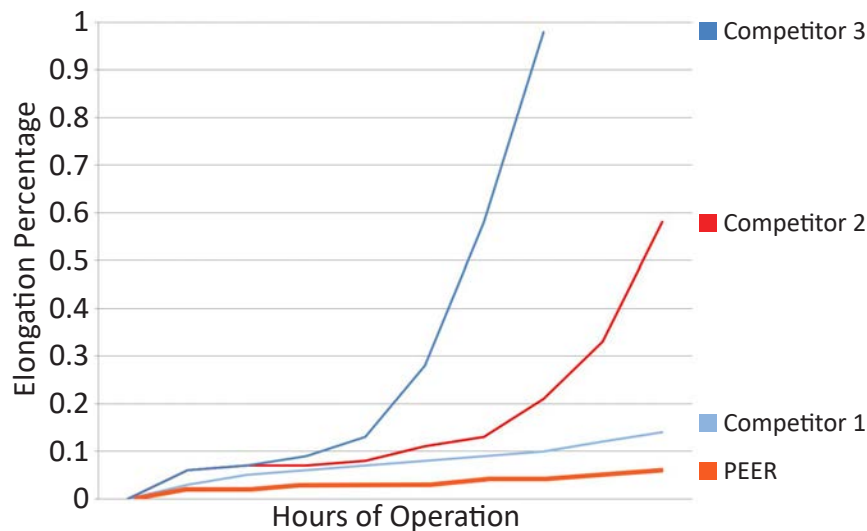

PEER Chain Advantages:

Maximized Sticker Sharpness

Solid Rollers and Solid Bushings

Pre-Loaded to Reduce Elongation

Heat Treated to Improve Chain Life

Provided in Matched Pairs



Dan Troxell,
Warehouse & Fulfillment
Center Manager

For a retired Marine like Dan (Trox to his friends), "quit" is not a part of his vocabulary! He works tirelessly with his team to ensure every shipment leaves his warehouse on time and up to our customers' expectations.



Kevin Shrout,
National Sales
Manager

Like a master chef, Kevin identifies the strengths of those around him and then works to coax those qualities to success. With more than 30 years of experience in distribution, it has proven a winning recipe!



Nety Park,
Technical Product
Manager

As a detail-oriented, team player, Nety finds happiness in helping others to solve problems. Like a superhero in one of her favorite movies, managing your most complex projects is something she enjoys doing every day!



Art Merwitz,
Director,
Sprocket Division

There's only one way to describe Art — a true die-hard! Whether his beloved Cubs or Sprockets, his passion is palpable. You can be sure that when you need a sprocket, Art is your guy to ensure it is perfectly paired!



Eric Ma,
Manager of Engineering
& Quality

A more befitting title could not be given to Eric, unless it also included something about his strength of character. Engineering and quality is what Eric lives, breathes, and embodies day in and day out.



Jeremy Fogo,
Vice President
Product, Solutions &
Experiences

A consummate people person, Jeremy finds the work he does with PEER customers incredibly rewarding. Being able to solve challenges for PEER customers is something that gets Jeremy out of bed each morning.



Chuck Briere,
Vice President
Strategic Alliances

What do you say about a guy who has been in the power transmission business for over 40 years? Chuck loves selling chain. Why? Because chain is a technical product, and he enjoys the mechanics and science of it.



Drew Beadle,
Product Manager

Drew grew up as a sponge surrounded by industrial and farm equipment. His quest to absorb technical and practical knowledge created an expertise in analyzing and creating quality customer solutions for all stakeholders.